



FS-1028MFP/FS-1128MFP

SETUP GUIDE



Please read this Setup Guide before using this machine. Keep it close to the machine for easy reference.

Introduction

About this Guide

This guide explains the following setting method necessary to use this machine.

Installation of the machine

- Unpacking
- Installing Toner Container
- Loading Paper
- Connecting Cables
- Connecting Modular Cords

Operation at the machine panel

- Selecting Language
- Date and Time Settings
- Setting Network Interface Parameters

Operation at the PC

- Accessing COMMAND CENTER (Internal HTML web page)
- Sharing Folder to use Scan to SMB
- Installing Printer Driver
- Setting TWAIN Driver
- Setting WIA Driver

IMPORTANT: Please read safety information on the Operation Guide before installing this machine.

Trademark Information

- Windows is a registered trademark of Microsoft Corporation in the U.S.A. and/or other countries.
- Windows XP and Windows Vista are trademarks of Microsoft Corporation.
- This machine contains the software having modules developed by Independent JPEG Group.

All other company and product names contained in this guide are trademarks or registered trademarks of their respective companies. The designations TM and [®] will not be used in this guide.

1 Preparations

Clearance

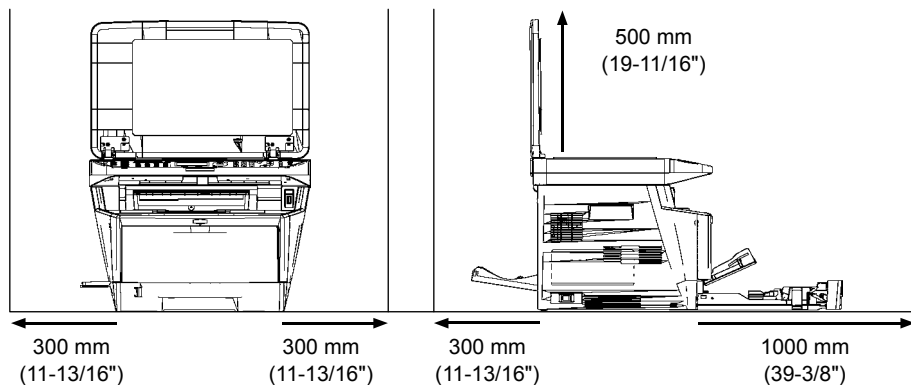

Environment

- Temperature: 10 to 32.5 °C (50 to 90.5 °F)
- Humidity: 15 to 80 %RH
- Power Supply: 120 V AC, 60 Hz, 7.4 A / 220 to 240 V AC, 50/60 Hz, 3.8 A



CAUTION: Be sure to provide enough space around machine. Prolonged use without sufficient clearance may cause overheating.

Unpacking

- 1 Unpack the machine and all its included components.

If the machine is FS-1128MFP, the modular cord with the attached ferrite core is enclosed.

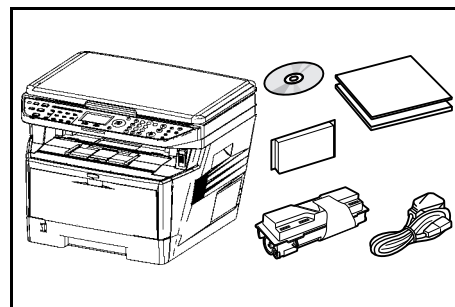

IMPORTANT: Place the machine in a stable position. When carrying the printer, always hold the right and left sides as shown.

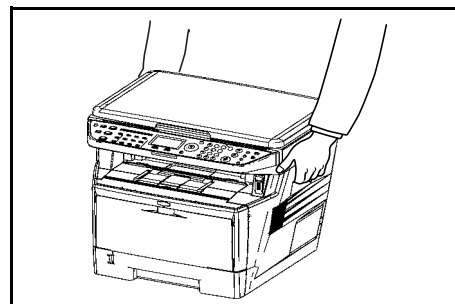

- 2 Remove the packing tape and the protective sheet.

- 3 Slide the Shipping Lock to the unlock position.

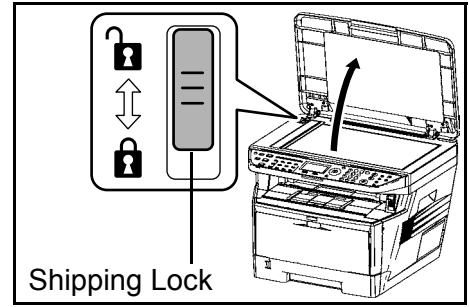

IMPORTANT: When installing the Document Processor, refer to Installation Guide attached to the Document Processor.

- 4 Attach the Guide Case to the machine right as required.

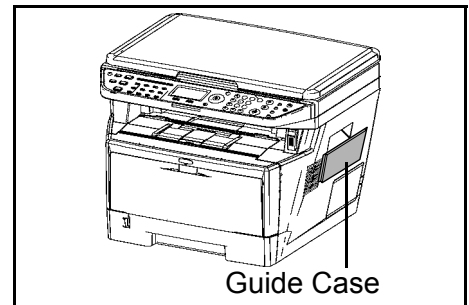

Installing Toner Container

- 1 Open the front cover.

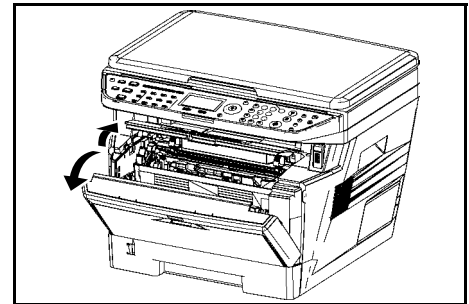

- 2 Remove the process unit from the machine.

IMPORTANT: Place the process unit on a clean, level surface where it will not be exposed to any sort of impact or shock. The drum in the process unit is sensitive to light and should not be exposed to normal office lighting for more than five minutes.

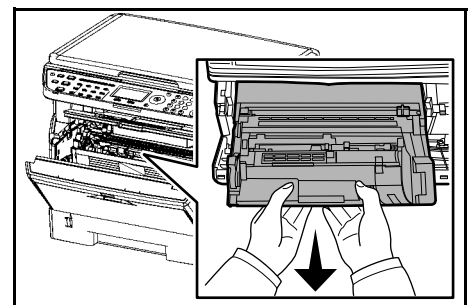

- 3 Check the lock lever to the **UNLOCK** position.

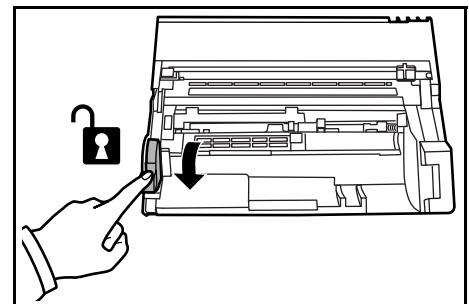

- 4** Shake the toner container horizontally 5 or 6 times so that the toner inside becomes evenly distributed.

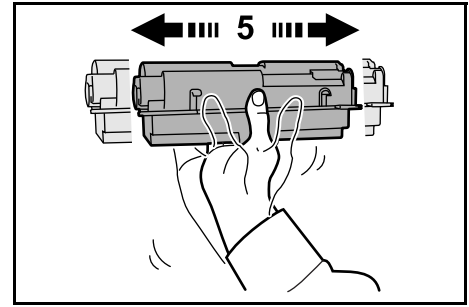

- 5** Remove the orange protective seal.

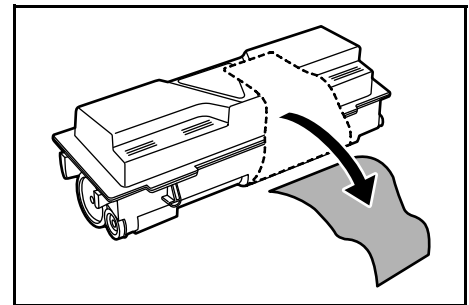

- 6** Align the knob on the left side of the container with the groove in the process unit and place the toner container into the process unit.

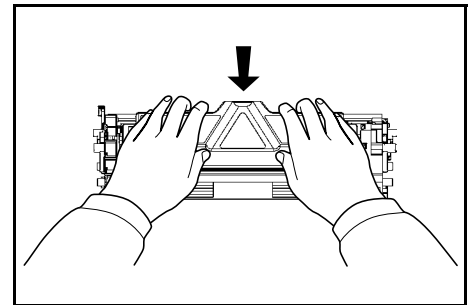

- 7** Push on the **PUSH** marks on the toner container until the container clicks into place.

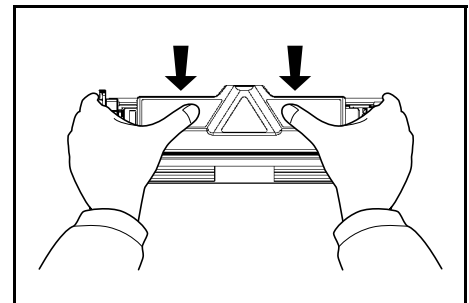

- 8** Push the lock lever back into its **LOCK** position (away from you).

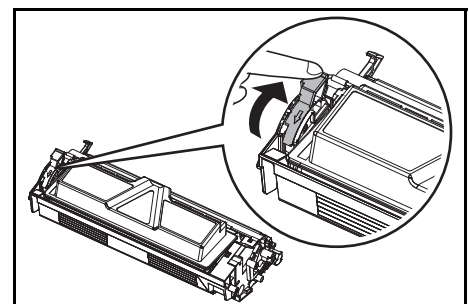

- 9** Align the pins on both sides of the process unit with the guides inside the machine, and slide the process unit into the machine until it stops.

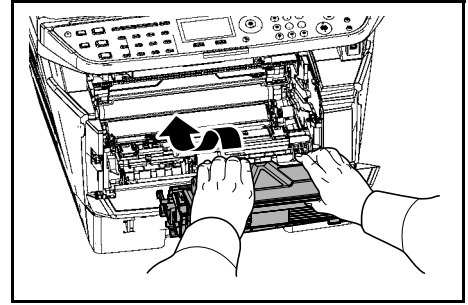

- 10** Close the front cover.

Loading Paper

- 1** Carefully pull the cassette all the way out of the machine and remove the protective packing from inside the cassette.

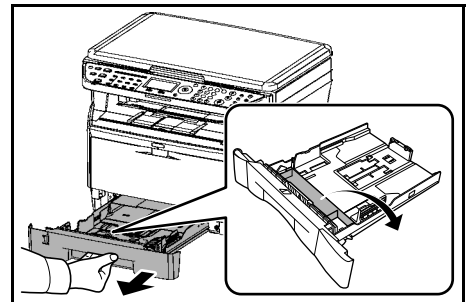

- 2** Adjust the paper length by pressing in on the release buttons and sliding paper stopper to fit the size of the paper. The paper sizes are marked on the bottom of the cassette.

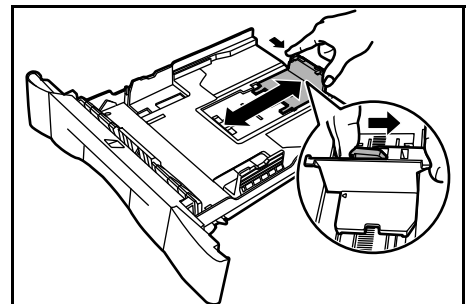

- 3** Adjust the paper width by pressing in on the release buttons and sliding the guides to fit the width of the paper.

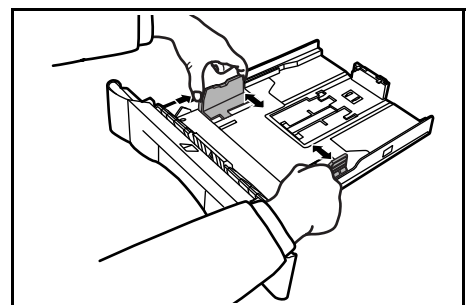

- 4** Fan the paper, then tap it on a level surface to avoid media jams or skewed printing.

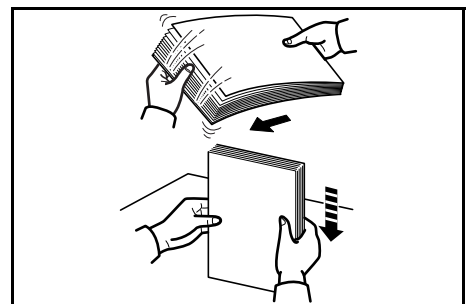

- 5** Place the paper in the cassette, with side to be printed downward, so that the leading edge is aligned against the paper stopper.

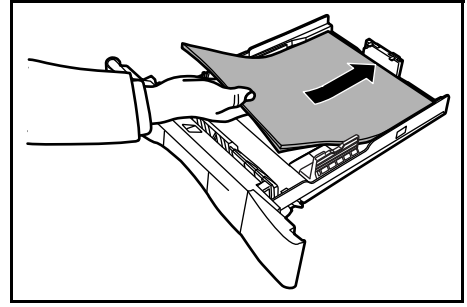

IMPORTANT: Do not exceed the upper limit of the cassette. Otherwise, it may cause paper jams.

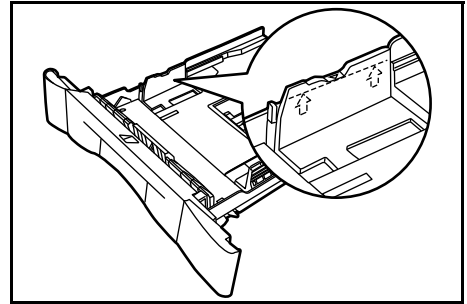

- 6** Push the cassette securely all the way back into the machine until it stops.

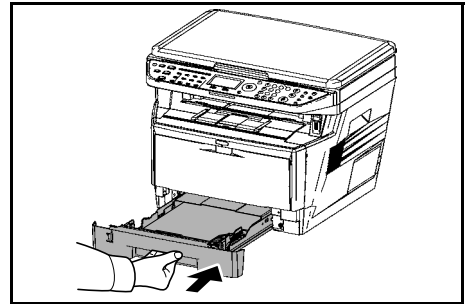

Connecting Cables

- 1** Turn the power switch off (O).

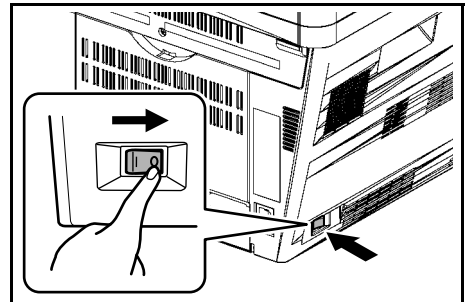

- 2** Connect the machine to the PC or your network device. When using the network interface, remove the cap. These cables are sold separately.

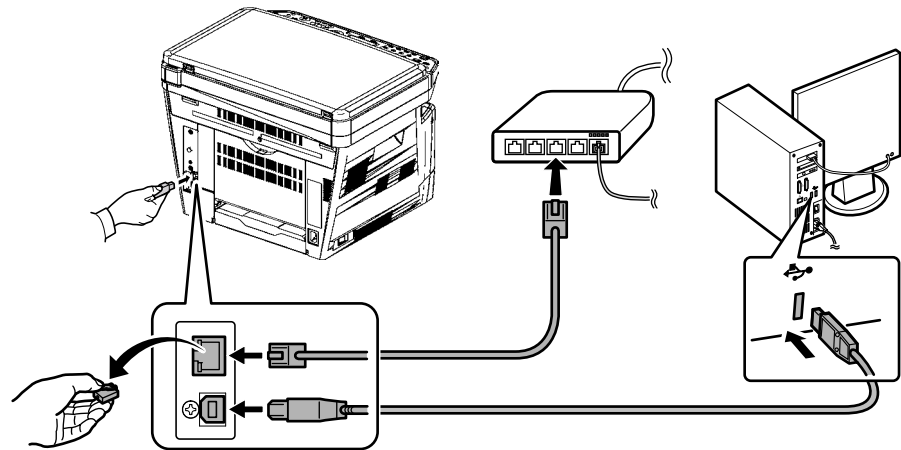

Available Standard Interfaces:

Interface	Function	Necessary Cable
Network Interface	Printer/Scanner/ Network FAX	LAN (10Base-T or 100Base-TX, Shielded)
USB Interface	Printer/TWAIN/ WIA	USB2.0 compatible cable (Hi-Speed USB compliant, Max. 5.0 m, Shielded)

- 3** Connect the power cord to the machine and the other end into a power outlet.

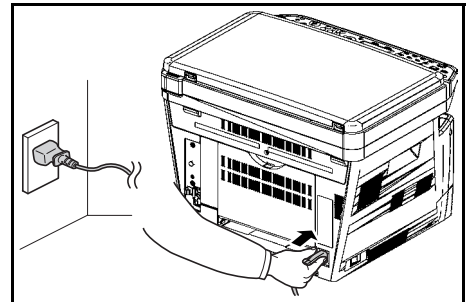

- 4** Turn the power switch on (I). The machine begins to warm up. The machine will begin replenishing the toner; this will take approximately 15 minutes.

Once the toner has been replenished, Ready to copy will appear on the message display.

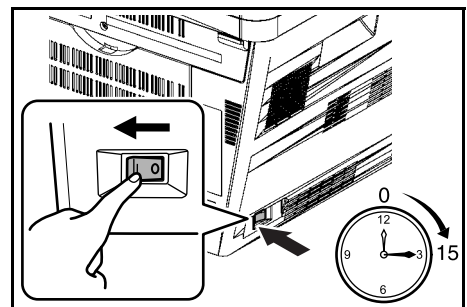

Connecting Modular Cords (FS-1128MFP only)

- 1 Turn the power switch off (O).

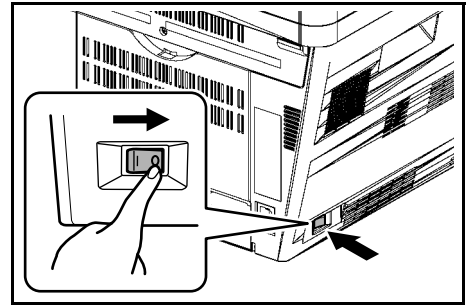

- 2 Connect the modular cord with the attached ferrite core to the line jack (A) of the machine. Then, connect the modular cord to the telephone jack (B) of the machine.

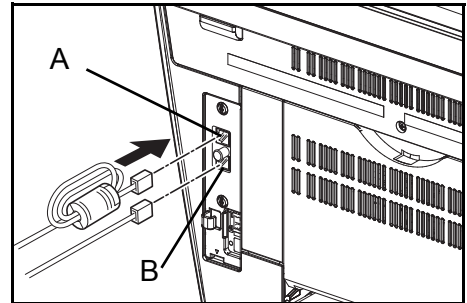

- 3 Route the cords as shown in the figure.

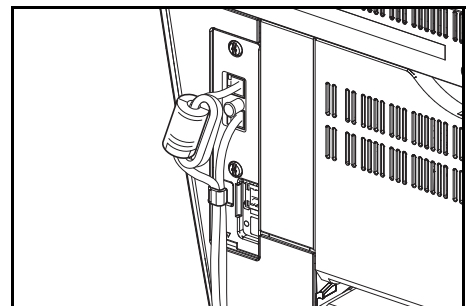

- 4 Turn the power switch on (I). The machine begins to warm up. If the machine is first installation, it will begin replenishing the toner; this will take approximately 15 minutes.

Once the toner has been replenished, *Ready to copy* will appear on the message display.

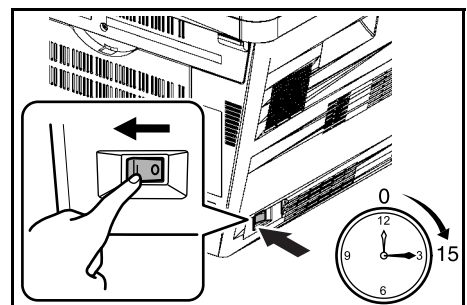

2 Panel Setup

Operation Panel

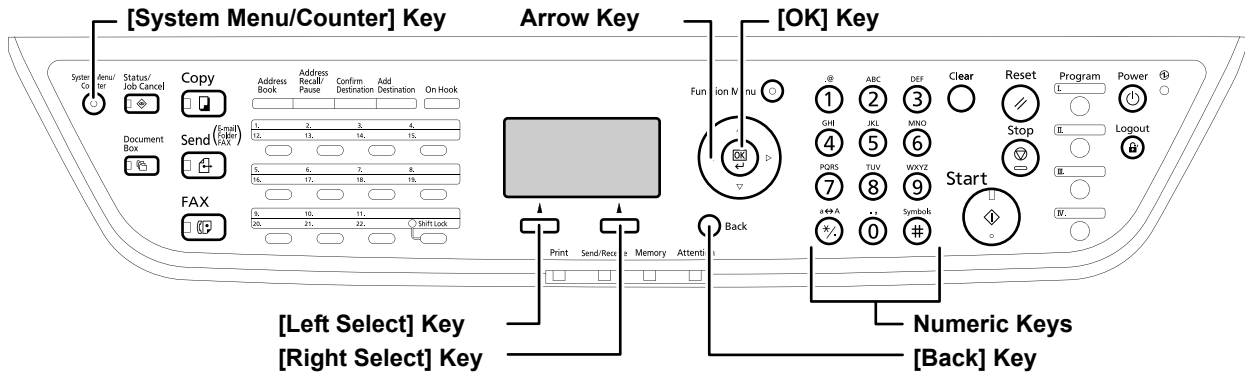

Selecting Language

Perform the following procedure to select the language of the message display. The default message language is English.

- 1** Press **[System Menu/Counter]**. The `Sys. Menu/Count.` screen appears.
- 2** Press Δ or ∇ (**[Arrow Key]**) to select `Common Settings`.
- 3** Press **[OK]**. The `Common Settings` screen appears.
- 4** Press Δ or ∇ to select `Language`.
- 5** Press **[OK]**. The `Language` screen appears showing the list of languages.
- 6** Press Δ or ∇ to select the desired language.
- 7** Press **[OK]**. The language is set and the `Common Settings` menu reappears.

Date and Time Settings

Setting the Time Zone

Perform the following procedure to select the time zone.

- 1** In the `Common Settings` menu, press Δ or ∇ to select `Date Setting`.
- 2** Press **[OK]**. The `Date Setting` screen appears.
- 3** Press Δ or ∇ to select `Time Zone`.

- 4 Press **[OK]**. The `Time Zone` screen appears.
- 5 Press Δ or ∇ to select the time zone that you are in.
- 6 Press **[OK]**. The time zone is set and the `Date Setting` menu reappears.

Summer Time Setting

Perform the following procedure to turn the summer (daylight saving) time setting on and off.

NOTE: This setting is valid only in the area where summer time is observed.

- 1 In the `Date Setting` menu, press Δ or ∇ to select `Summer Time`.
- 2 Press **[OK]**. The `Summer Time` screen appears.
- 3 Press Δ or ∇ to select whether summer time is enabled.
- 4 Press **[OK]**. The summer time is set and the `Date Setting` menu reappears.

Setting the Current Date and Time

Perform the following procedure to set the current date and time.

NOTE: Periodically check the time that is shown in the message display and adjust as necessary to match the current time.

- 1 In the `Date Setting` menu, press Δ or ∇ to select `Date/Time`.
- 2 Press **[OK]**. The `Date/Time` screen (month:day:year) is appears.
- 3 To set the date, for each field press Δ or ∇ as many times as necessary to display the correct value then press \triangleright to move to the next field.

Use \triangleleft and \triangleright to move the cursor right and left.
- 4 When the date is correct, press **[OK]**. The time setting screen (hour:minute:second) is appears.
- 5 To set the time, for each field press Δ or ∇ as many times as necessary to display the correct value then press \triangleright to move to the next field.
- 6 Press **[OK]**. The date and time is set and the `Date Setting` menu reappears.

Setting Network Interface Parameters

This machine supports TCP/IP and TCP/IP (IPv6) protocols. IP is an abbreviation for Internet Protocol. This machine routinely uses the TCP/IP (IPv4) protocol, but provides a separate setting for the next generation IP, IPv6. Configure the printer's network parameters as appropriate for your PC and your network environment.

IMPORTANT: Check with your network administrator when selecting the network setting. After all network related settings have been done, turn the machine Off and On again.

TCP/IP (Enable/Disable TCP/IP)

This selects the settings for TCP/IP.

- 1** Press **[System Menu/Counter]**. The *Sys. Menu/Count.* screen appears.
- 2** Press Δ or ∇ to select *System*.
- 3** Enter the user ID and password to log in.

NOTE: The default settings of user ID and password are both 2800.

- 4** Press **[OK]**. The *System* screen appears.
- 5** Press Δ or ∇ to select *Network Setting*.
- 6** Press **[OK]**. The *Network Setting* screen appears.
- 7** Press Δ or ∇ to select *TCP/IP Setting*.
- 8** Press **[OK]**. The *TCP/IP Setting* screen appears.
- 9** Press Δ or ∇ to select *TCP/IP*.
- 10** Press **[OK]**. The *TCP/IP* screen appears.
- 11** Press Δ or ∇ to select whether TCP/IP is enabled.
- 12** Press **[OK]**. The TCP/IP is set and the *TCP/IP Setting* menu reappears.

IPv4 Settings (TCP/IP IPv4 settings)

This selects the settings for TCP/IP (IPv4).

- 1** In the *TCP/IP Setting* menu, press Δ or ∇ to select *IPv4 Setting*.
- 2** Press **[OK]**. The *IPv4 Setting* menu screen appears.

The options available in the TCP/IP (IPv4) settings are as follows:

- DHCP (DHCP setting)
- Bonjour (Bonjour setting)
- IP Address (IP address setting)
- Subnet Mask (Subnet mask setting)
- Default Gateway (Gateway setting)

DHCP

- 1 In the `IPv4 Setting` menu, press Δ or ∇ to select `DHCP`.
- 2 Press **[OK]**. The `DHCP` screen appears.
- 3 Press Δ or ∇ to select whether `DHCP` is enabled.
- 4 Press **[OK]**. The `DHCP` is set and the `IPv4 Setting` menu reappears.

Bonjour

- 1 In the `IPv4 Setting` menu, press Δ or ∇ to select `Bonjour`.
- 2 Press **[OK]**. The `Bonjour` screen appears.
- 3 Press Δ or ∇ to select whether `Bonjour` is enabled.
- 4 Press **[OK]**. The automatic `Bonjour` is set and the `IPv4 Setting` menu reappears.

IP Address

- 1 In the `IPv4 Setting` menu, press Δ or ∇ to select `IP Address`.
- 2 Press **[OK]**. The `IP Address` screen appears.
- 3 Use the arrow keys to set the IP address.
Press Δ and ∇ to increase or decrease, respectively, the value at the blinking cursor. You can set any value between 000 and 255.
Use \triangleleft and \triangleright to move the cursor right and left.
- 4 Press **[OK]**. The IP address is stored and the `IPv4 Setting` menu reappears.

Subnet Mask

- 1 In the `IPv4 Setting` menu, press Δ or ∇ to select `Subnet Mask`.
- 2 Press **[OK]**. The `Subnet Mask` screen appears.
- 3 Use the arrow keys to set the subnet mask.
Press Δ and ∇ to increase or decrease, respectively, the value at the blinking cursor. You can set any value between 000 and 255.
Use \triangleleft and \triangleright to move the cursor right and left.
- 4 Press **[OK]**. The subnet mask is stored and the `IPv4 Setting` menu reappears.

Default Gateway

- 1 In the IPv4 Setting menu, press Δ or ∇ to select Default Gateway.
- 2 Press [OK]. The Default Gateway screen appears.
- 3 Use the arrow keys to set the default gateway.
Press Δ and ∇ to increase or decrease, respectively, the value at the blinking cursor. You can set any value between 000 and 255.
Use \triangleleft and \triangleright to move the cursor right and left.
- 4 Press [OK]. The default gateway is stored and the IPv4 Setting menu reappears.

IPv6 Setting (TCP/IP IPv6 settings)

This selects the settings for TCP/IP (IPv6).

- 1 In the TCP/IP Setting menu, press Δ or ∇ to select IPv6 Setting.
- 2 Press [OK]. The IPv6 Setting menu screen appears.

The options available in the TCP/IP (IPv6) settings are as follows:

- TCP/IP(IPv6) (Enable/disable TCP/IP (IPv6))
- Prefix Length (Prefix Length setting)
- RA(Stateless) (RA (Stateless) setting)
- DHCPv6 (DHCPv6 setting)

TCP/IP(IPv6)

- 1 In the IPv6 Setting menu, press Δ or ∇ to select TCP/IP (IPv6).
- 2 Press [OK]. The TCP/IP (IPv6) screen appears.
- 3 Press Δ or ∇ to select whether TCP/IP (IPv6) is enabled.
- 4 Press [OK]. The TCP/IP(IPv6) is set and the IPv6 Setting menu reappears.

Prefix Length

- 1 In the IPv6 Setting menu, press Δ or ∇ to select Prefix Length.
- 2 Press [OK]. The Prefix Length screen appears.
- 3 Use the arrow keys to set the default gateway.
Press Δ or ∇ to increase or decrease, respectively, the value at the blinking cursor. You can set any value between 0 and 128.
Use \triangleleft and \triangleright to move the cursor right and left.
- 4 Press [OK]. The Prefix Length is set and the IPv6 Setting menu reappears.

DHCPv6

- 1 In the IPv6 Setting menu, press Δ or ∇ to select DHCPv6.
- 2 Press [OK]. The DHCPv6 screen appears.
- 3 Press Δ or ∇ to select whether DHCPv6 is enabled.
- 4 Press [OK]. The DHCPv6 is set and the IPv6 Setting menu reappears.

RA(Stateless)

- 1 In the IPv6 Setting menu, press Δ or ∇ to select RA(Stateless).
- 2 Press [OK]. The RA(Stateless) screen appears.
- 3 Press Δ or ∇ to select whether RA(Stateless) is enabled.
- 4 Press [OK]. The RA(Stateless) is set and the IPv6 Setting menu reappears.

AppleTalk (AppleTalk setting)

AppleTalk is a communications protocol used primarily on Macintosh computers and also refers to the Mac OS network functions. The default setting is On.

- 1 Press [System Menu/Counter]. The Sys. Menu/Count. screen appears.
- 2 Press Δ or ∇ to select System.
- 3 Press [OK]. The System screen appears.
- 4 Press Δ or ∇ to select Network Setting.
- 5 Press [OK]. The Network Setting screen appears.
- 6 Press Δ or ∇ to select AppleTalk.
- 7 Press [OK]. The AppleTalk screen appears.
- 8 Press Δ or ∇ to select whether AppleTalk is enabled.
- 9 Press [OK]. The AppleTalk is set and the Network Setting menu reappears.

3 Accessing COMMAND CENTER

COMMAND CENTER refers to the internal HTML web page that is installed in the machine from which you can verify the operating status of the machine and make settings related to security, network printing, e-mail transmission and advanced networking.

- 1 Run the web browser.
- 2 In Address or Location, enter the machine IP address as the URL, e.g. *http://192.168.110.171/*. The web page displays basic information about the machine and COMMAND CENTER as well as the current status of the machine.
- 3 Select a category from the navigation bar on the left to view and set values for that category.
- 4 Setting Administrator Password restricts general users' access to pages other than the Start page. For security purposes, setting the Administrator password is highly recommended. The default Administrator password is factory-set as **admin00**.

Network Settings

This page allows you to make the settings that are required for network printing and sending e-mail. You must restart this machine after you have completed these settings in order to properly register the content of those settings in the machine.

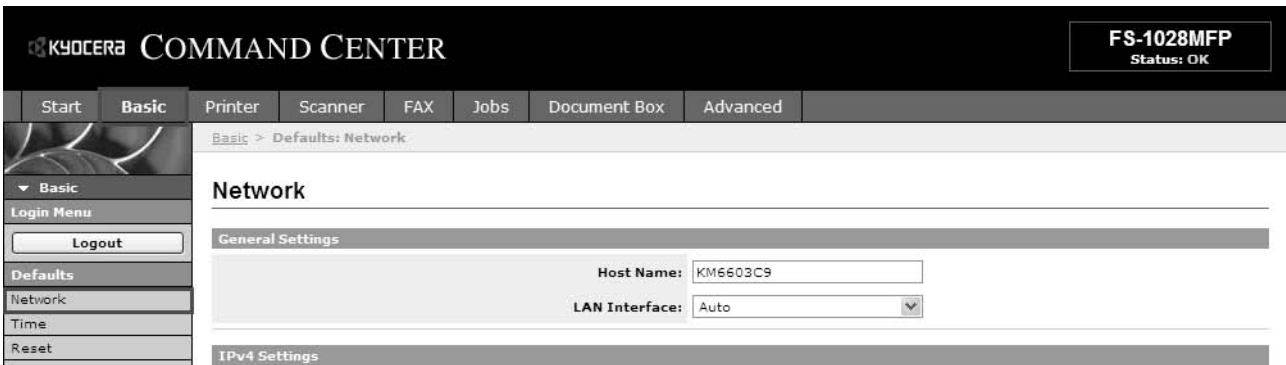

- 1 Click **Basic -> Network**.
- 2 Enter the correct settings in each field. The table below provides a summary of the items displayed on the Network page.

Item	Description
Host Name	Specifies a name for the printing system network component. This name is used as the NetBEUI printer name and as the WSD device name.
LAN Interface	Specifies the communication rate from Auto , 10BASE-T-Half , 10BASE-T-Full , 100BASE-TX-Half , and 100BASE-TX-Full .

Item	Description
IPv4 Settings DHCP/BOOTP	Specifies whether or not to automatically obtain an IP address using DHCP or BOOTP.
IP Address (IPv4)	Assigns the Internet Protocol address on the printing system network component. The format of the IP address is four-byte (32-bit) numbers separated by dots, e.g. 192.168.110.171.
Subnet Mask	Specifies the subnet mask of the hosts or network with which the print system is connecting. If you have manually assigned an IP address that starts with a number between 192 and 223, it is recommended that you set the subnet mask to "255.255.255.0."
Default Gateway	Specifies the IP address of the default gateway.
IPv6 Settings IPv6	Specifies whether or not to enable the IPv6 protocol. Select On to use the IPv6 protocol.
IP Address (IPv6)	Assigns an IPv6 address to the printing system network component. The format of the IPv6 address is a sequence of numbers (128 bit in total) separated by colons, e.g. 2001:db8:3c4d:15::1a2c:1a1f.
Prefix Length	Specifies the IPv6 prefix length of the hosts or network with which the print system is connecting.
RA (Stateless)	Select On to use RA to configure IPv6 addresses.
Default Gateway	Specifies the IPv6 address of the default gateway.
DHCPv6	Specifies whether or not to obtain IPv6 IP addresses by automatic configuration. When RA is turned On , the IP addresses and server information are obtained via DHCPv6 based on the settings of the automatic configuration made under RA (router setting).

3 Click **Submit**.

E-mail Settings

The following procedure explains the method for attaching scan data to e-mail for transmission. Scan to e-mail works within the following environments:

- It must have a network environment in which this machine can connect to a mail server. It is recommended that the machine be used in an environment in which it can connect to the mail server at any time over a LAN.
- The SMTP settings must be completed. Use COMMAND CENTER, to register the IP address and the host name of the SMTP server.
- There may be a times where transmission is not possible due to the size of each e-mail item.

The scanner system network component offers e-mail function. SMTP is an embedded protocol to support this function. To use the e-mail function, the scanner system needs connection to an e-mail server using the POP3 protocol.

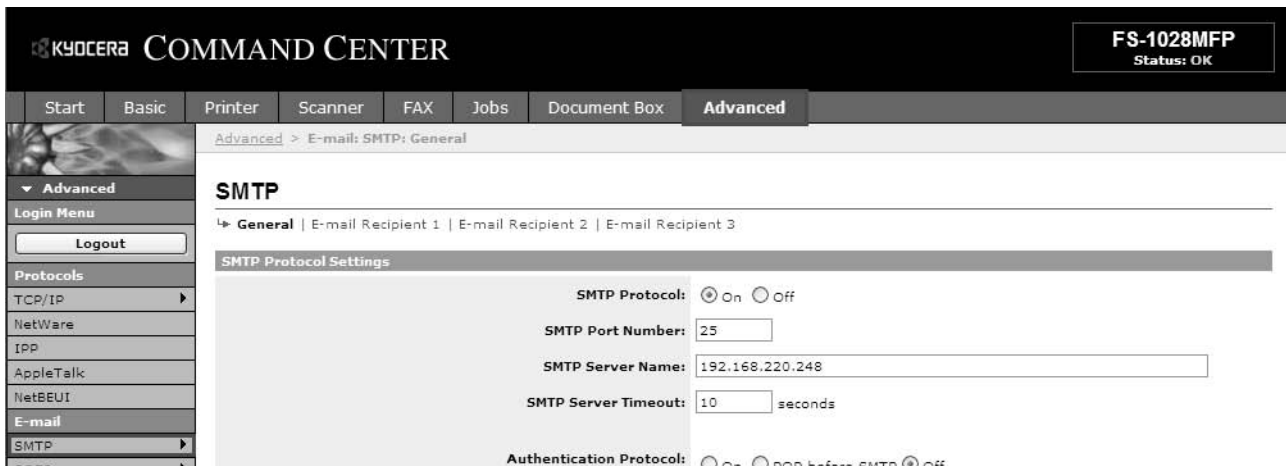

- 1 Click **Advanced** -> **SMTP** -> **General**.
- 2 Enter the correct settings in each field. The table below provides a summary of the items displayed on the SMTP Protocol Settings page.

Item	Description
SMTP Protocol	Enables or disables SMTP protocol. To use e-mail, this protocol must be enabled.
SMTP Port Number	Set the SMTP Port Number or use the SMTP default port 25.
SMTP Server Name	Enter the SMTP server name or its IP address. If entering the name, rather than the IP address, a DNS server address must also be configured. The DNS server address may be entered on the TCP/IP General tab.
SMTP Server Timeout	Sets the timeout in seconds during which this machine tries to connect to the SMTP server.
Authentication Protocol	Enables or disables the SMTP authentication protocol or sets POP before SMTP as the protocol. The SMTP authentication supports Microsoft Exchange 2000.
Authenticate as	Specifies the user to be authenticated in SMTP authentication. When POP3 User 1 to 3 and iFAX User are set, you can select one of them. If you want to select a different user, select Other and enter the login account name and login password for authentication.
Login User Name	When Other is selected for Authenticate as , the account name set here will be used for SMTP authentication.
Login Password	When Other is selected for Authenticate as , the password set here will be used for authentication.
POP before SMTP Timeout	Enter the timeout in seconds during which this machine tries to connect to the SMTP server when set POP before SMTP as the Authentication Protocol .
Test	Tests to confirm that the settings on this page are correct. When the Test button is pressed, this machine tries to connect to the POP3 server.
E-mail Size Limit	Enter the maximum size of e-mail that can be sent in Kilobytes. When the value is 0, the limitation for E-mail size is disabled.

Item	Description
Sender Address	Enter the E-mail address of the person responsible for the printing system, such as the printer administrator, so that a reply or non-delivery report will go to a person rather than to the machine. The sender address must be entered correctly for SMTP authentication. Note that no mail message can be sent unless the sender's address is specified.
Signature	Enter the signature. The signature is free form text that will appear at the end of the e-mail body. It is often used for further identification of the machine.
Domain Restriction	Enter the domain names that can be permitted or rejected. You can also specify the e-mail addresses.

3 Click **Submit**.

Enabling SMB Function

Stores the image data of scanned originals as a file in a desired folder on your PC. Enables SMB parameters in COMMAND CENTER.

In order to access the PC, you must consult the administrator to check the following information on each server and register them to this machine.

- Login user name and Password (using operation panel)
- Host name or IP address of the PC
- Port number
- Path (path from the home directory of the PC to the folder for storage)
- Shares the destination's PC folder (Refer to *Sharing PC Folder on page 22*)

Login username and Login password are identical to the Windows User logon on the PC from which the accessed folder is stored. User access rights for the machine to the necessary folder should be registered within Windows on that PC.



1 Click **Scanner** -> **SMB**.

2 Enter the correct settings in each field. The table below provides a summary of the items displayed on the scanner SMB page.

Item	Description
SMB Protocol	Switches the SMB Protocol On or Off .
SMB Port Number	Set the SMB default Port Number or use the SMB default port 139 (For Windows Vista, use 445).

3 Click **Submit**.

Enabling FTP Function

The FTP transmission function converts the data of originals scanned on this machine to the PDF, TIFF, JPEG, or XPS format and uploads it directly to an FTP server. Enable FTP parameters in COMMAND CENTER.

In order to access a FTP server, you must consult the server administrator to check the following information on each server and register them to this machine.

- Login user name (using operation panel)
- Password (using operation panel)
- Host name or IP address of FTP server
- Port number (normally 21)
- Path (path from the home directory of the FTP server to the folder for storage)
- Shares the FTP server

Login username and Login password are identical to the FTP User login. The FTP user account for the machine needs to be installed and administrated at the FTP server.

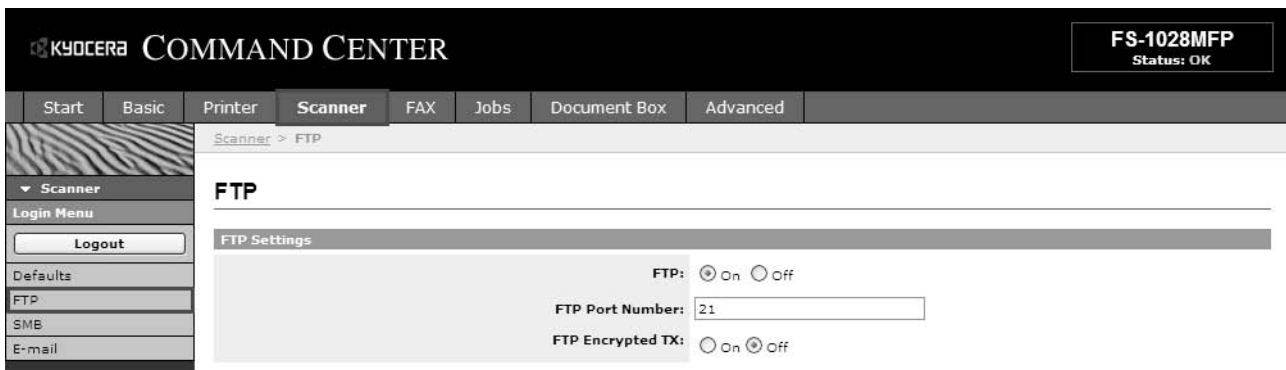

1 Click **Scanner** -> **FTP**.

2 Enter the correct settings in each field. The table below provides a summary of the items displayed on the scanner FTP page.

Item	Description
FTP	Switches FTP On or Off .
FTP Port Number	Set the FTP Port Number or use the FTP default port 21.
FTP Encrypted TX	This enables or disables Encryption for communication. When turned On , data communications are encrypted using the one of the following algorithms.
Encryption	This allows you to specify the encryption algorithm for data communication. You can use more than one algorithms at a time. (This is possible by turning FTP Encrypted TX to On .)

3 Click **Submit**.

Editing Address Book

This machine has an address book function. When an e-mail address, the path of PC folder (SMB), FTP server's path, FAX, and i-FAX number are registered in the address book, it can transmit directly from the operation panel. This page allows you to add, edit or delete Contacts or Groups.

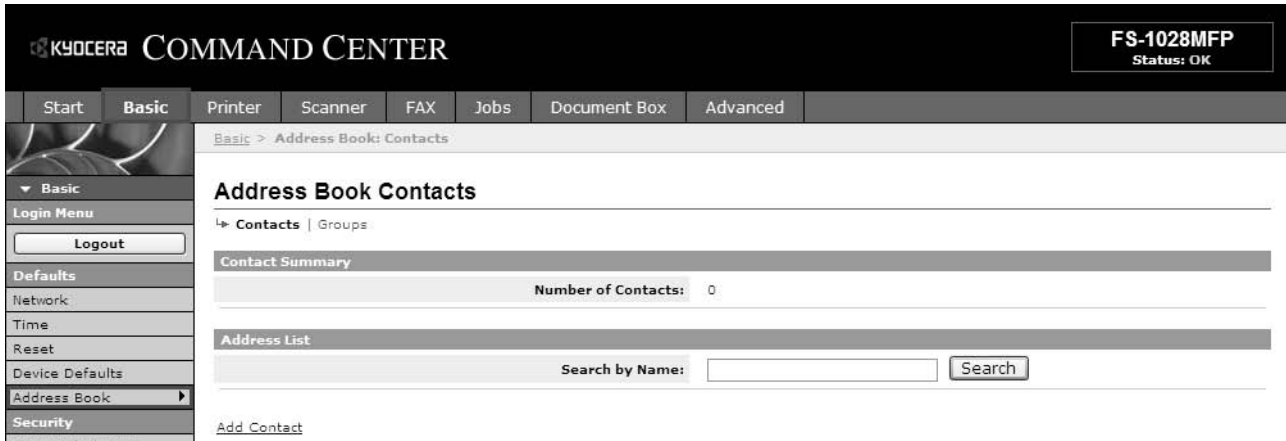

Adding a New Contact

- 1 Open the **Address Book Contacts** page.
- 2 Click **Add Contact**. The **Address Book Contacts - Add** page opens.
- 3 Enter the information for the contact to be registered. You can specify a FAX number and i-FAX even if the FAX System is not installed.
- 4 Click **Submit**.

Adding a New Group

- 1 Open the **Address Book Groups** page.
- 2 Click **Add Group**. The **Address Book Groups - Add** page opens.
- 3 Enter the number and name of the group.
- 4 Click **Submit**. The **Address Book Groups - Add Members** page opens.
- 5 Select the members to be added to the created group. Check the members you want to add. The members must be registered before added.
- 6 After you have selected the members, click **Submit**. The **Address Book Groups - Edit** page opens. Click **Submit**. You can continue editing groups, such as changing group names and adding or deleting members.

4 Sharing PC Folder

To use Scan to SMB (PC) function, a "shared folder" must be set up with the destination computer to receive data.

IMPORTANT: To use Scan to SMB (PC) function, the machine must be connected to a TCP/IP network.

The next section explains how to send data to a domain controlled computer.

Configuring Windows Firewall (for Windows Vista)

If the destination of files is a Windows Vista-based computer, you must configure Windows Firewall exceptions. With exceptions, enable file and printer sharing and add a port you want use for the Scan to SMB (PC).

IMPORTANT: Log on to Windows with administrator privileges.

- 1 On the **Windows Firewall Settings** dialog box, click the **Exceptions** tab. From the **Start** menu, select **Control Panel** and click **Allow a program through Windows Firewall**.
- 2 At the **User Account Control** consent prompt, click **Continue**.
- 3 Click the checkbox under **File and Printer Sharing**, then click **Apply**.

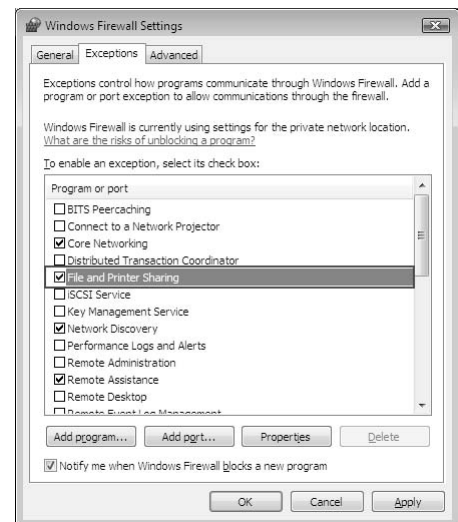

- 4 Click **OK**.

Creating Shared Folder

Create a shared folder to receive data in the destination computer. Share the folder by enabling folder sharing on a normal folder. The following example explains how to create a folder named "scannerdata" on drive C.

IMPORTANT: Log on to Windows with administrator privileges.

NOTE: The following description is one example of screenshots of Windows XP. The details differ depending on the type of operating system.

- 1 Create a folder named "scannerdata" on drive C.
- 2 Right-click the "scannerdata" folder and select **Sharing and Security....** The **scannerdata Properties** dialog box appears.
- 3 Select **Share this folder**.
- 4 Click **Permissions**. The **Permissions for scannerdata** dialog box appears.



- 5 Select the group or user to whom you want to grant permissions for the shared folder.

NOTE: The following example explains how to grant permissions for **Everyone**. **Everyone** is the setting that allows any users to share the folder over the network. Click **Add** to add groups or users that are selectable from the **Group or user names**. Use this setting if you want to limit the access to the shared folder to specific users or groups.

- 6 Click the checkbox under **Allow for Change and Read**, then click **OK** of the **Permissions** dialog box.

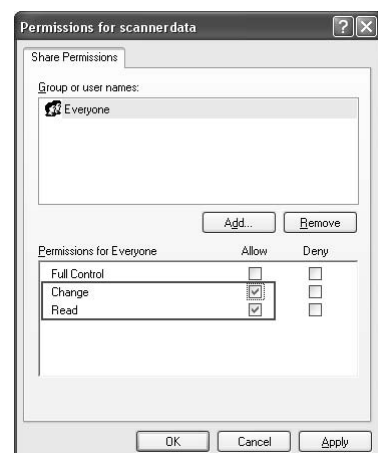

- 7 Click the **Security** tab, then click **Add**.

- 8 Add the user name displayed in the **Group or user names**. Click **Add**, then click **Locations**. Select the computer to which the shared folder was created (Example: PC4050) and then click **OK**.
- 9 Enter the user name added as a local user into the text box and click **OK**.
- 10 Select the added user, click the checkbox under **Allow** for **Modify** and **Read**, then click **OK**.
- 11 Click **OK** to close the **Properties** dialog box.

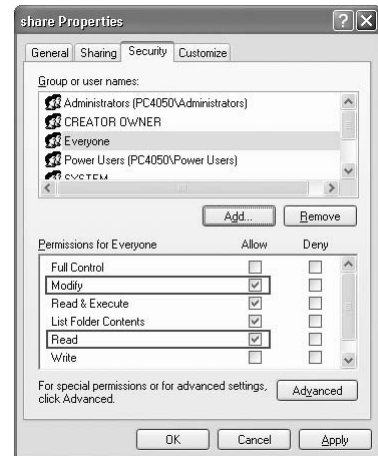
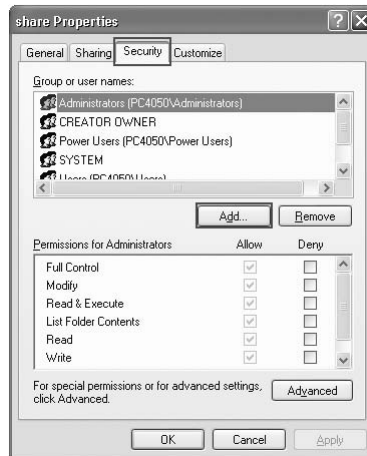

Specifying Destination

Check the computer information required to enter on the touch panel when sending a file. The information you require to check using the computer is:

- Entry for Host Name
- Entry for Path
- Entry for Login User Name

Checking the Entry for Host Name

Check the name of the destination computer.

- 1 Right-click **My Computer** and select **Properties**. The **System Properties** dialog box appears.
- 2 Click the **Computer Name** tab to view the name of computer.

If the Computer Name tab contains Full computer name and Domain

The characters to the left of the first dot (.) in the **Full computer name** text box correspond to the entry for Host Name. (Example: pc4050)

If the Computer Name tab contains Full computer name and Workgroup

All characters in the **Full computer name** text box correspond to the entry for Host Name. (Example: PC4050)

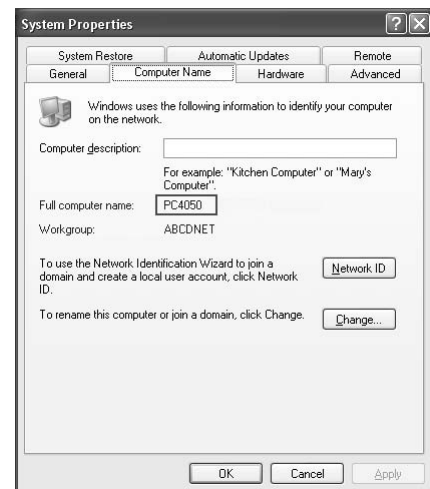
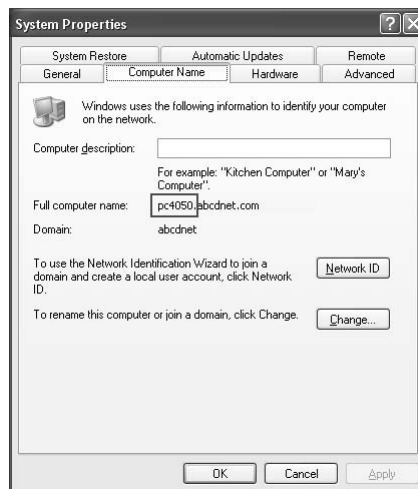

Checking the Entry for Path

Check the share name for the shared folder to which data is sent.

- 1 Click **Search** in the **Start** menu. The **Search Result** page opens.
- 2 Search the destination computer to which the file is sent. In the **Search Companion**, click **Printers, Computers, or people**, and then click **A computer on the network**.
- 3 On the **Computer name** text box, type the name of computer (pc4050) you checked on page 24, and then click **Search**.
- 4 Double-click the name of computer (pc4050) displayed on the search results.
- 5 Double-click the "scannerdata" folder and check the full path displayed in the **Address Bar**. The characters to the right of the third backslash (\) correspond to the entry for Path.
(Example: scannerdata)

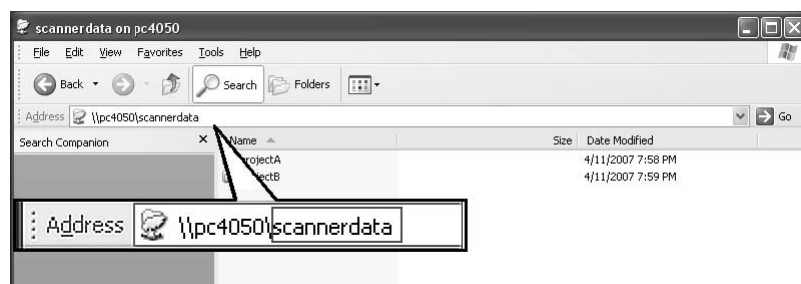

NOTE: You must use alphabets, numerals, and symbols (ASCII codes from 0 × 20 to 0 × 7F) only to enter Path.

You can specify a subfolder in the shared folder as the location where data is to be sent. In this case, the entry for Path is "share name\name of a folder in the shared folder". In the sample window above, "scannerdata\projectA" corresponds to Path.

Checking the Entry for PathName

You can use the following steps to check the domain name and user name that must be entered in Login User Name.

- 1 Open the **Command Prompt** window. From the **Start** menu, select **All Programs, Accessories** and then **Command Prompt**.
- 2 At the **Command Prompt**, enter “net config workstation” and then press **Enter**.

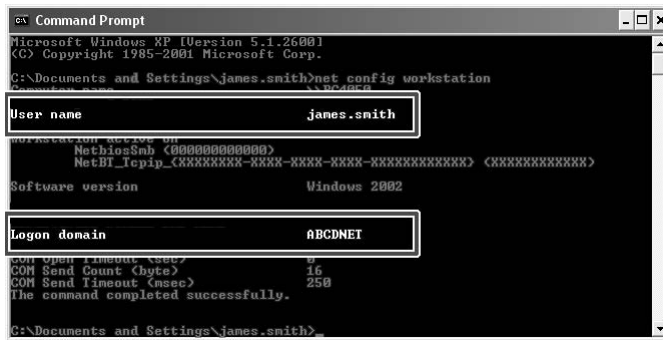

```
Command Prompt
Microsoft Windows XP [Version 5.1.2600]
(C) Copyright 1985-2001 Microsoft Corp.
C:\Documents and Settings\james.smith>net config workstation
User name                james.smith
NetbiosSmb               (000000000000)
NetBI_Tcpip              (XXXXXXXX-XXXX-XXXX-XXXXXXXXXXXXXXXX) (XXXXXXXXXXXX)
Software version         Windows 2002
Logon domain             ABCDNET
COM Open Timeout (sec)   0
COM Send Count (byte)   16
COM Send Timeout (msec) 250
The command completed successfully.
C:\Documents and Settings\james.smith>
```

5 Installing Printer Driver

Ensure the machine is plugged in and connected to the PC before installing the printer driver from the CD-ROM.

Installing Printer Driver in Windows

If you are connecting this machine to a Windows PC, follow the next steps to install the printer driver. The example shows you how to connect your machine to a Windows Vista PC.

NOTE: In Windows Vista, Windows XP and Windows 2000, you must be logged on with administrator privileges.

You can use either Express Mode or Custom Mode to install the software. Express Mode automatically detects connected machines and installs the required software. Use Custom Mode if you want to specify the printer port and select the software to be installed.

- 1 Turn on the computer and start up Windows.

If the Welcome to the Found New Hardware Wizard dialog box displays, select **Cancel**.

- 2 Insert the CD-ROM supplied with the machine into the optical drive of the PC. In Windows Vista, the user account management window appears. Click **Allow**.

The installation program launches.

NOTE: If the software install wizard does not launch automatically, open the CD-ROM window in Windows Explorer and double-click **Setup.exe**.

- 3 Click **View License Agreement** and read the License Agreement. Click **Accept**.

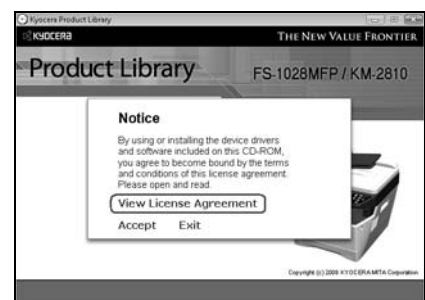

- 4 Click **Install Software**. The software install wizard starts up.

From this point, the procedure differs depending on your version of Windows and your connection method. Proceed to the correct procedure for your connection type.

- Express Mode
- Custom Mode



Express Mode

In Express Mode, the installer automatically detects the machine when it is turned on. Use Express Mode for standard connection methods.

- 1 In the installation method selection window, select **Express Mode**. The print system detection window appears and the installer detects the connected machines. If the installer does not detect a print system, check that the print system is connected via USB or a network and that it is turned on. Then return to the print system detection window.

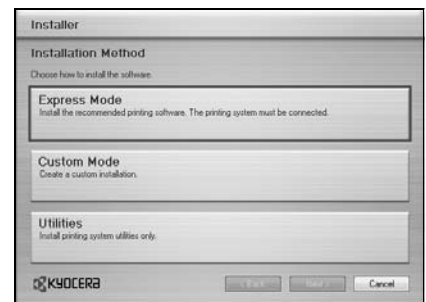

NOTE: While the information shown in Windows Vista and Windows XP installation dialog boxes differs slightly, the installation procedure is the same.

- 2 Select the print system to be installed and click **Next**.

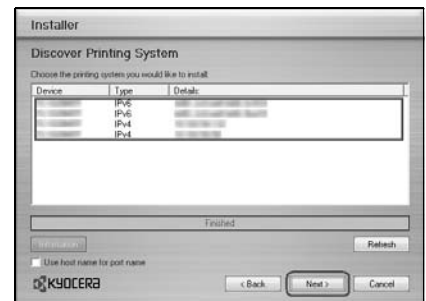

- 3 You can customize the print system name in the installation settings window. This will be the name displayed in the Printer window and in the printer lists displayed in applications. Specify whether to share the print system name or set the print system as an existing machine and then click **Next**.



IMPORTANT: Step 3 only appears if the print system is connected via a network. It does not appear if the print system is connected via a USB.

- 4 A window appears in which you can check the settings. Check the settings carefully and then click **Install**.

NOTE: If the Windows security window appears, click Install this driver software anyway.

- 5** A message appears saying that the printer has been installed successfully. Click Finish to exit the printer installation wizard and return the CD-ROM main menu.

If the device setup dialog box appears after you click Finish, you can specify the settings for items such as optional features installed in the print system. You can also specify the device settings after you exit the installation. For details, refer to Device Settings in the printer driver operation manual on the CD-ROM.

This completes the printer driver installation procedure. Follow the on-screen instructions to restart the system, if required.

Custom Mode

Use Custom Mode if you want to specify the printer port and select the software to be installed. For example, if you do not want fonts installed on your computer to be replaced, select **Custom Mode** and deselect the **Fonts** checkbox in the utility tab.

NOTE: Install TWAIN driver or WIA driver on your computer in this mode.

- 1** Select **Custom Mode**.

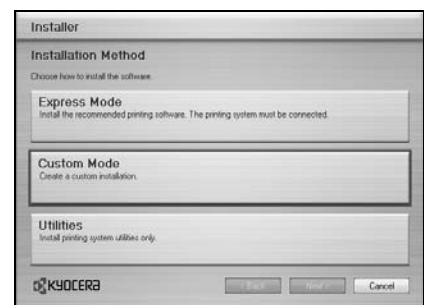

- 2** Following the instructions in the install wizard window, select the software packages to be installed and the specify the port, etc. For details, refer to Custom Installation in the printer driver operation manual on the CD-ROM.

Installing Printer Driver in Macintosh

- 1** Turn on the machine and the Macintosh.
- 2** Insert the included CD-ROM (Product Library) into the CD-ROM drive.
- 3** Double-click the CD-ROM icon.
- 4** Double-click either **OS X 10.2 and 10.3 Only** or **OS X 10.4 or higher** depending on your Mac OS version.

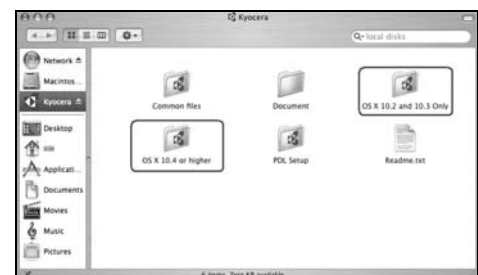

- 5 Double-click **Kyocera OS X vx.x**.

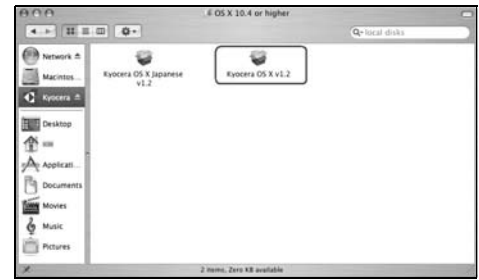

- 6 The printer driver installation program starts up.



- 7 Choose **Select Destination, Installation Type** and then install the printer driver as directed by the instructions in the installation software.

In addition to **Easy Install**, the **Installation Type** options include **Custom Install**, which allows you to specify the components to be installed.

IMPORTANT: In the Authenticate screen, enter the name and password used to log in to the operating system. This completes the printer driver installation. Next, specify the print settings. If an IP or AppleTalk connection is used, the settings below are required. If a USB connection is used, the machine is automatically recognized and connected.

- 8 Open **System Preferences** and click **Print & Fax**.



- 9 Click the plus symbol (+) to add the installed printer driver.

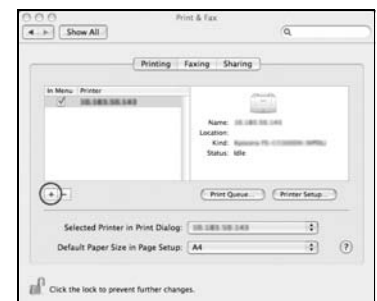

- 10** Click the IP icon for an IP connection or the AppleTalk icon for an AppleTalk connection and then enter the IP address and printer name.

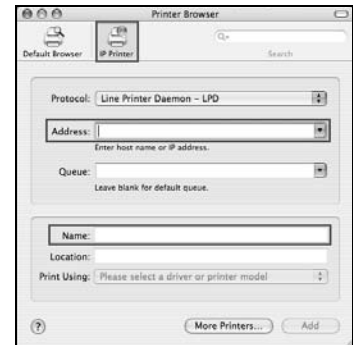

- 11** Select the installed printer driver and click **Add**.

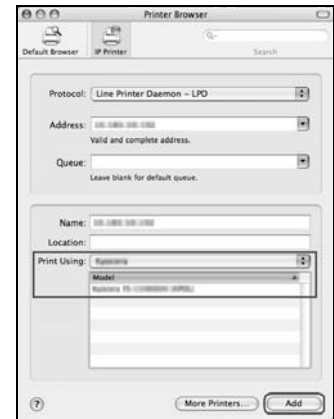

- 12** Select the options available for the machine and click **Continue**.



- 13** The selected machine is added. This completes the printer setup procedure.



Setting TWAIN Driver

Register this machine to the TWAIN Driver.

- 1** Select **Start** button of the Windows display, **All Programs**, **Kyocera** and then **TWAIN Driver Setting**.

NOTE: You can also add the machine to a PC when selecting **Start** of the Windows display, **Control Panel** and then **Kyocera TWAIN**.

- 2** Click **Add**.

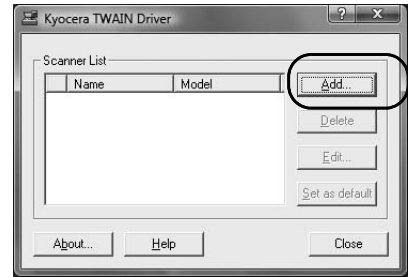

- 3** Enter the machine name in the Name field.

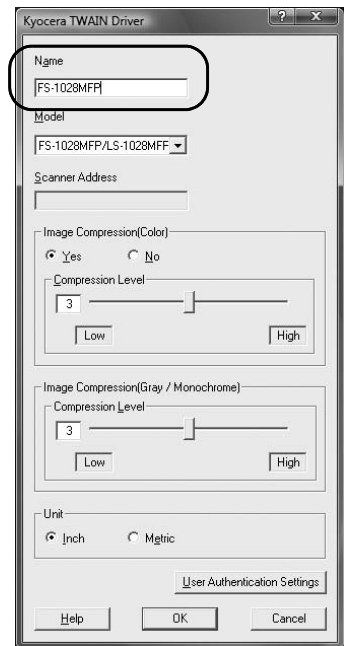

- 4** Click ▼ next to the Model field and select this machine from the list.
- 5** Enter the machine's IP address or host name in the Scanner Address.

NOTE: When the machine's IP address is unknown, contact Administrator.

- 6** Click **User Authentication Settings**. If user login administration is invalid, go to Step 8.
- 7** Select the checkbox beside Authentication, enter Login User Name (up to 64 characters) and Password (up to 64 characters) and then click **OK**.



- 8 Click OK.
- 9 The machine is registered to the PC and the machine name and model name are displayed in the **Scanner List** field.

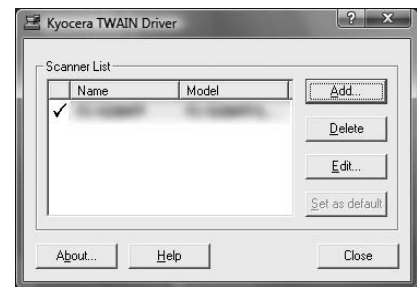

NOTE: Click **Delete** to delete the added machine. Click **Edit** to change names.

Setting WIA Driver (Windows Vista™ and Windows® Server 2008)

Register this machine to the WIA Driver.

NOTE: The following is not necessary to register when using the machine possesses an IP address or host name that you have specified during installation of WIA Driver.

- 1 Select **Start** of the Windows display, **Control Panel** and then **Scanners and Cameras**.
- 2 Select the same name as this machine from WIA Drivers, and press the **Properties**.

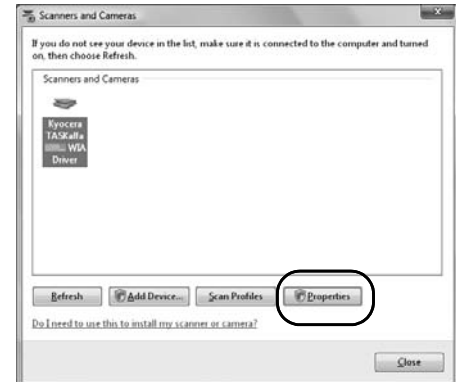

NOTE: If Windows Security and User Account Control are displayed, no trouble should be found with operation after installing the driver and software we have provided. Continue installation.

- 3 Click the **Settings** tab and select the **Image Compression** and the **Compression Level**. If user login administration is invalid, go to Step 5.

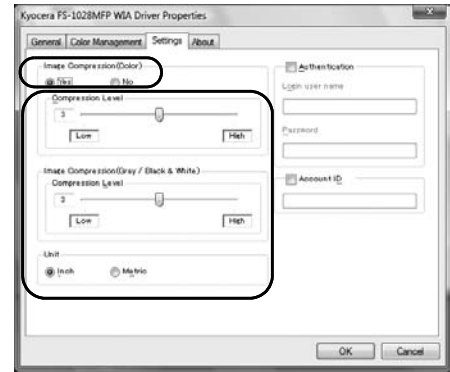

NOTE: When the machine's IP address is unknown, contact Administrator.

- 4 Select the checkbox beside **Authentication**, enter Login User Name (up to 64 characters) and Password (up to 64 characters) and then click **OK**.
- 5 Click **Close**.

The machine is registered to the PC.

